

TAV 2 DI 5

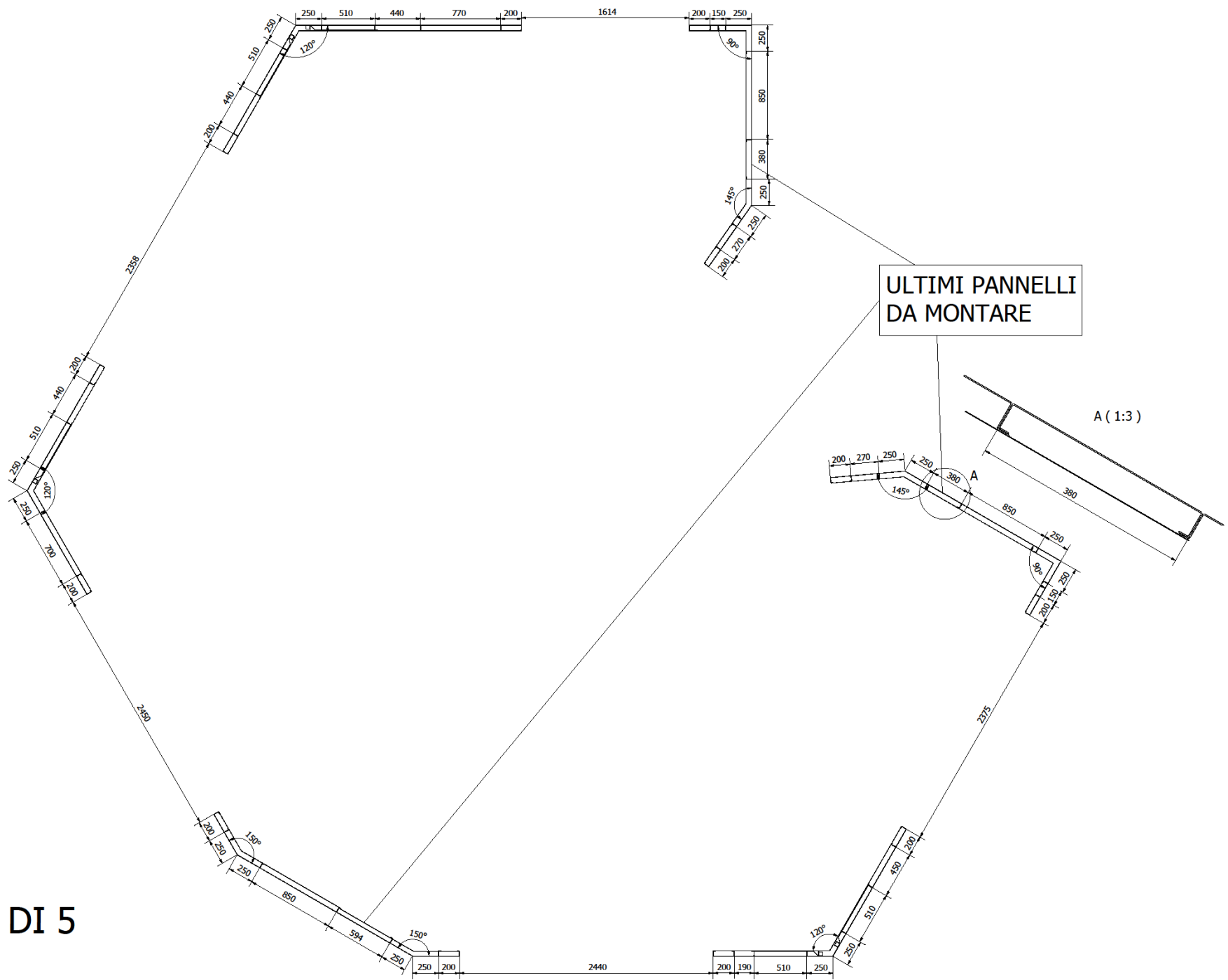

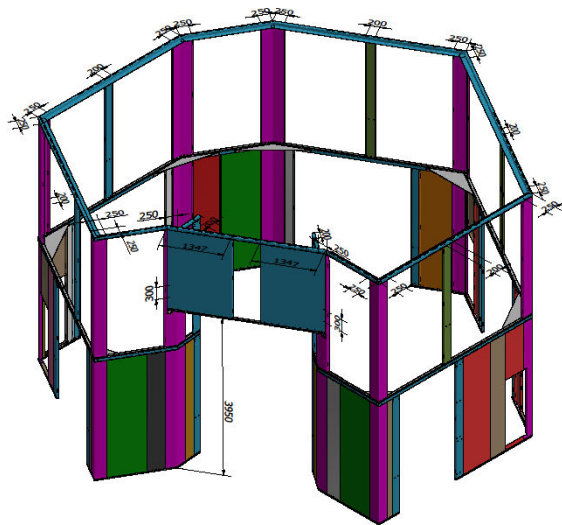

5° FASE DI MONTAGGIO
 montare tutti i pannelli angolo
 poi la "U" sopra e poi i pannelli
 da 200mm

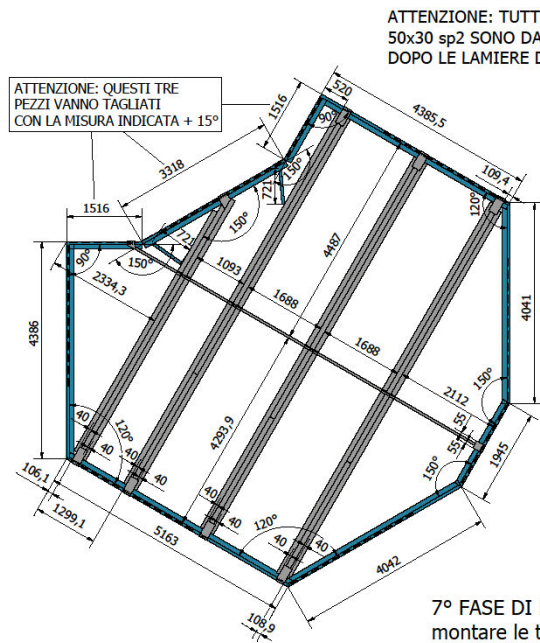

7° FASE DI MONTAGGIO
 montare le travi 150x100 sp2

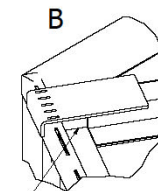
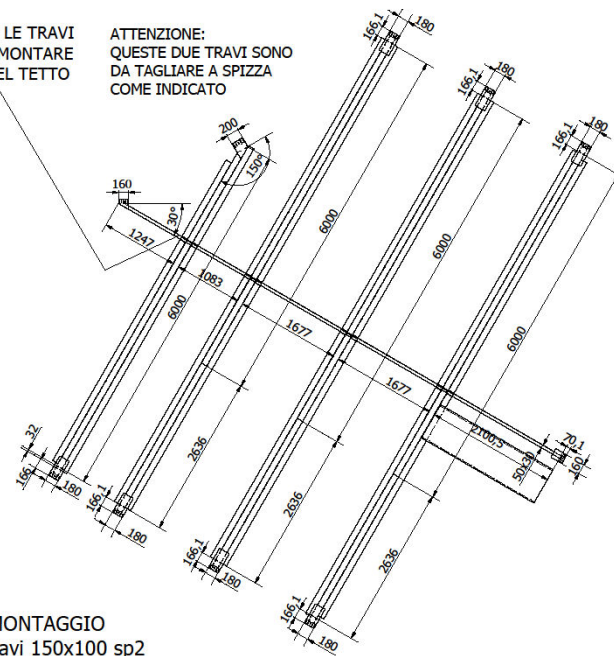

U-sostegno-trave.1pt
 S235 SP. 5,00 mm R 3,40 mm
 PESO 0,8 kg

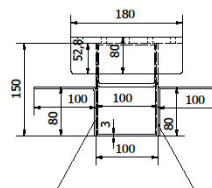

SALDARE "APPOGGIO-TETTO"
 ALLA TRAVE 150x100

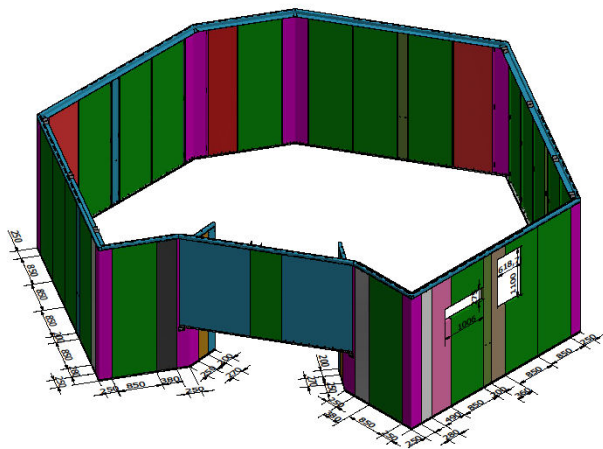

6° FASE DI MONTAGGIO
 montare i pannelli vedi quote e
 tipo di profili nella tavola 4

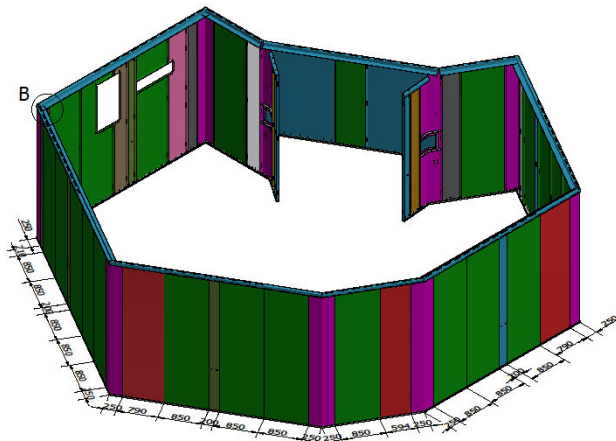

TAV 3 DI 5

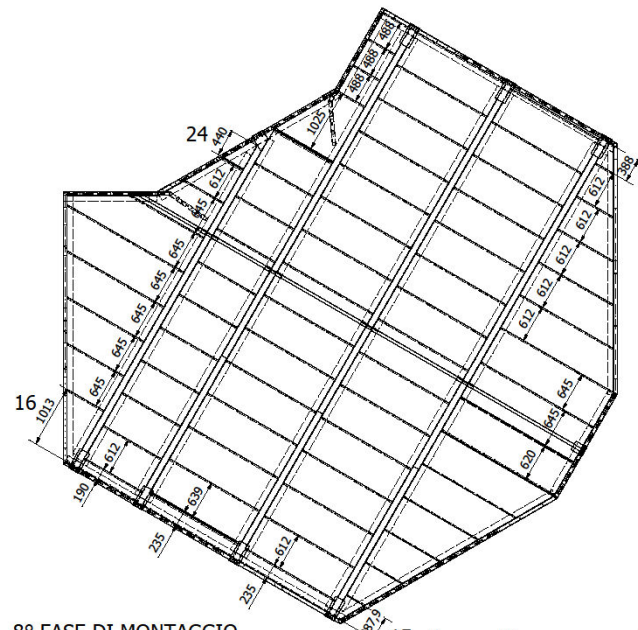

8° FASE DI MONTAGGIO
 montare le lamiera del tetto
 e le travi 50x30

15 I pannelli sono numerati
 solo dall' 1 al 15 e
 dal 16 al 24

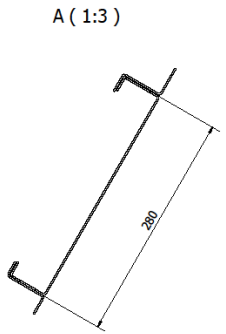
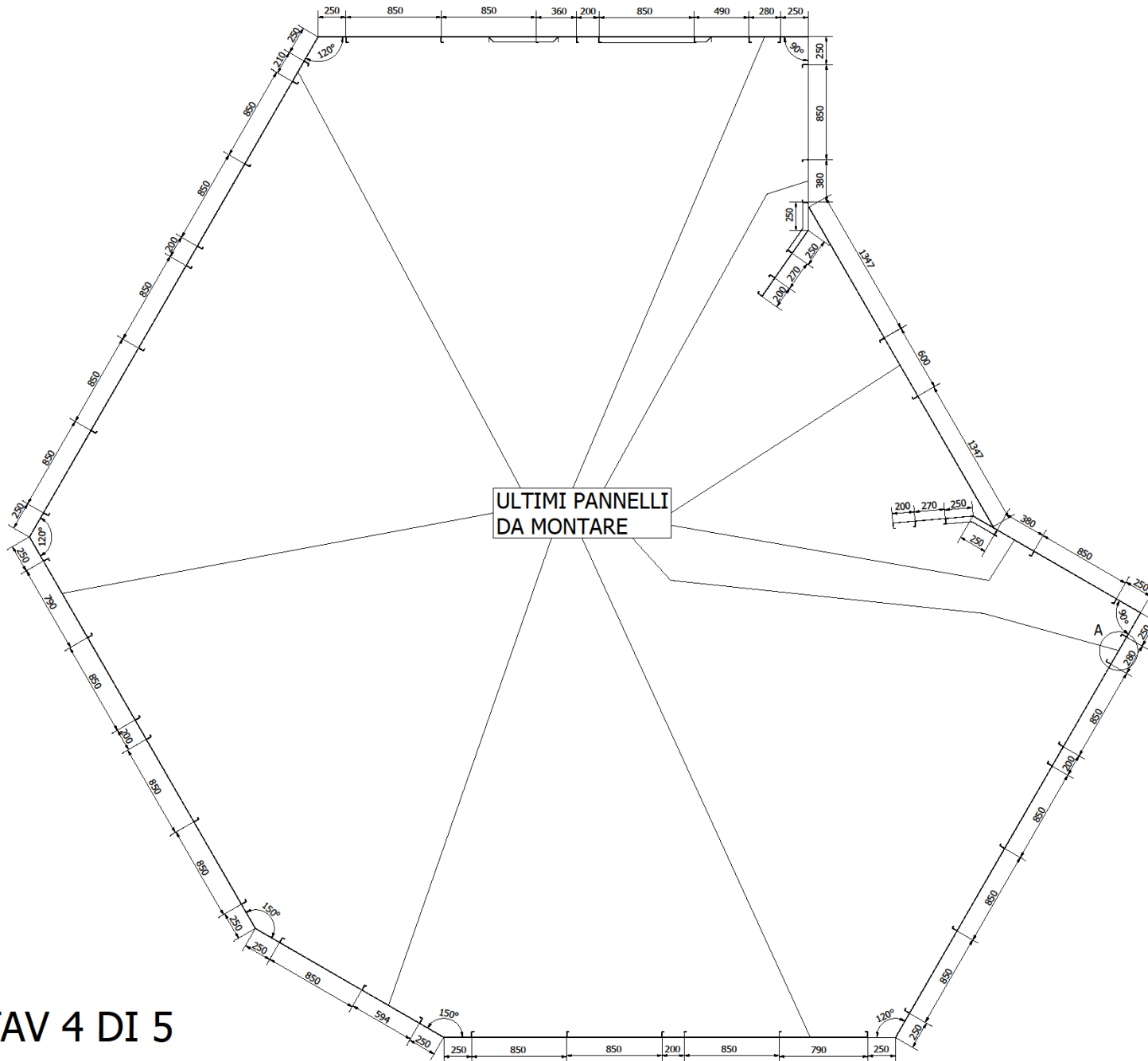

TAV 4 DI 5

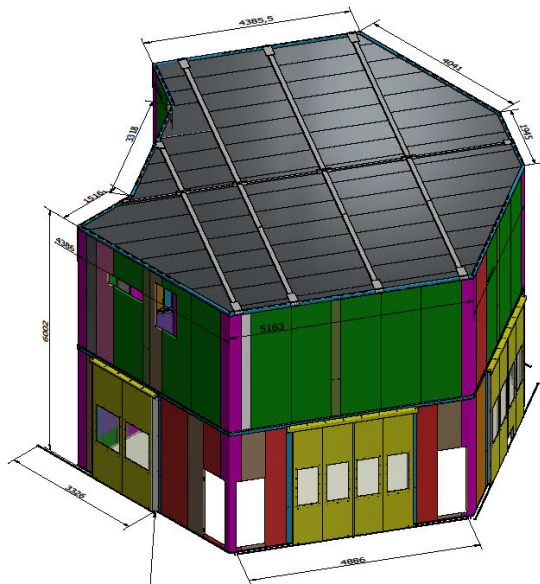

battuta_porta_pq18006.ipt
 S235 SP, 2,00 mm R 1,70 mm
 PESO 11,0 kg

**BATTUTA DI CHIUSURA PORTE
 SALDATE NEL CENTRO DELLA GUIDA**

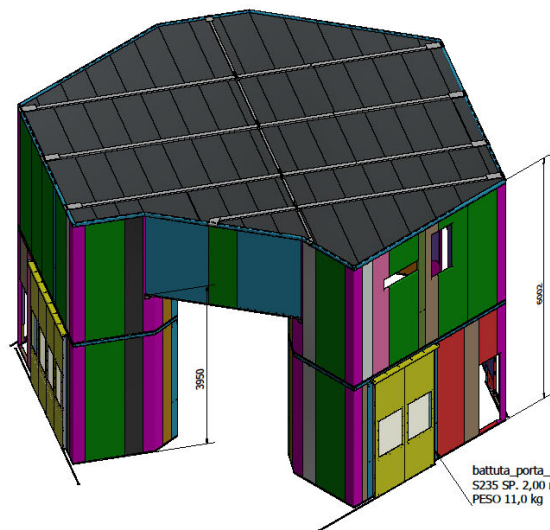
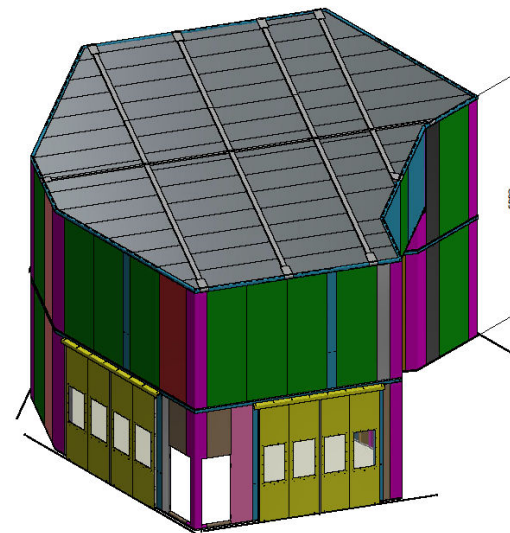
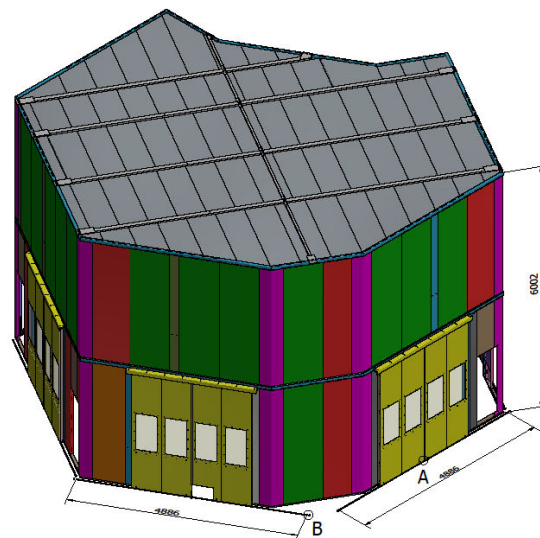

battuta_porta_pq18006.ipt
 S235 SP, 2,00 mm R 1,70 mm
 PESO 11,0 kg

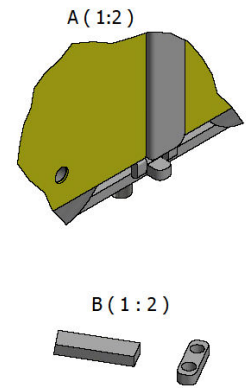

**FISSARE A TERRA LA BATTUTA DELLA PORTA QUANDO
 E' TUTTA APERTA A SECONDO DELL'APERTURA DELLA PORTA**